



BACKSIGHT and FORESIGHT

26th  
ISV Regional Conference

22-24 March 2013

# *Information*

*Where the bloody hell is it?*

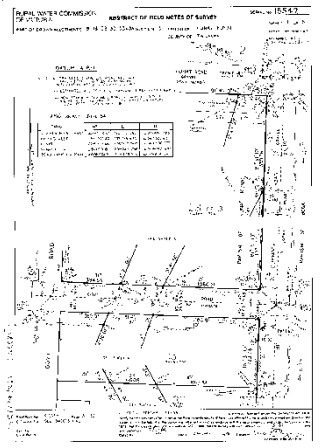

Paul F Kenny  
Consultant Surveyor

[ppkenny@aapt.net.au](mailto:ppkenny@aapt.net.au)

[www.paulkennyconsulting.com.au](http://www.paulkennyconsulting.com.au)



*Information  
where the bloody hell  
is it?*

In the beginning there was the  
***SR&WSC***  
followed by the  
***RWC - Commission***  
and another one  
***RWC - Corporation***  
and finally  
***GMW – Goulburn Murray Water***  
***and other water authorities***

*Information  
where the bloody hell  
is it?*

**Survey information  
passed from:**

**SR&WSC**



**RWC**



**GMW**

**Why?**



**Surveyors & Draughting  
staff were involved**



*Information  
where the bloody hell  
is it?*

## What was involved?

- Survey Fieldnotes and Reports
- Plans – Survey and Engineering
- Survey Benchmarks and Locality Plans
- Order in Council Plans

*Information  
where the bloody hell  
is it?*

## What was involved?

- Aerial photography
- Corporate Files
- Level books and Survey Fieldbooks

*Information  
where the bloody hell  
is it?*

## *1. Survey Fieldnotes*

- Approximately 16,000 transferred.
- State coverage
- Original linen or plastic.
- Surveyor's Report
- Fieldnotes and Surveyor's Reports scanned
- Currently not all are in GMW document system
- Can be readily accessed

*Information  
where the bloody hell  
is it?*

## *1. Survey Fieldnotes*

To search for a set of fieldnotes you need:

- Fieldnote No. if you know it.
- Crown Allotment, Section, Block, Lot No.
- Parish
- Descriptor

*Information  
where the bloody hell  
is it?*

## *1. Survey Fieldnotes*

*GMW will charge a fee for searching out  
information*

Contact

Glenn Collins at [glennc@g-mwater.com.au](mailto:glennc@g-mwater.com.au)

or

Avni Bekirofski at [avnib@g-mwater.com.au](mailto:avnib@g-mwater.com.au)



*Information  
where the bloody hell  
is it?*

**1. Survey Fieldnotes**  
Examples of fieldnotes

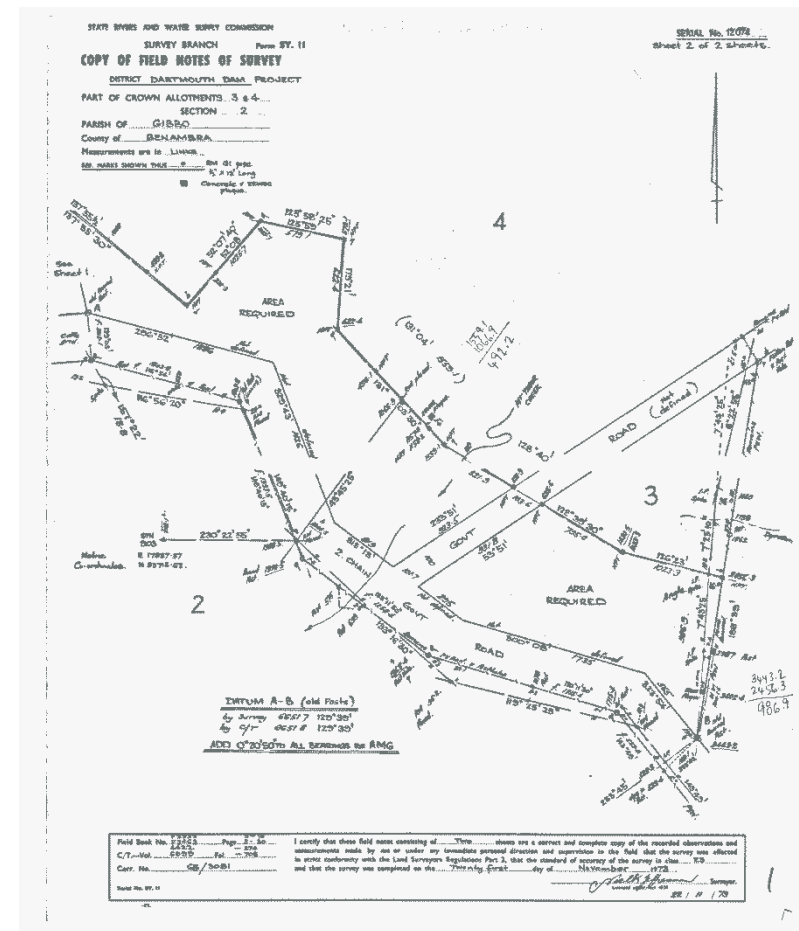
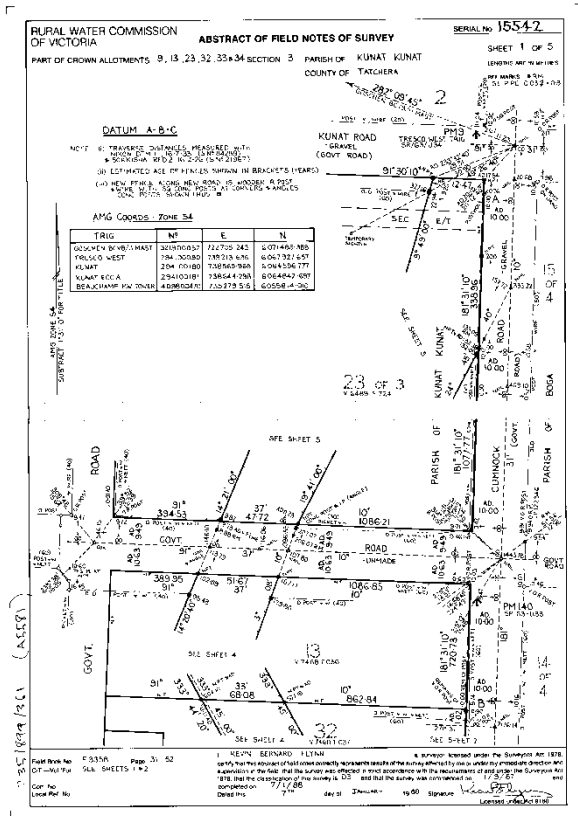

*Information  
where the bloody hell  
is it?*

## *2. Survey and Engineering Plans*

- Survey and Engineering plans were broken up into the various water authorities.
- GMW received between 140,000 to 200,000
- At GMW plans are held as:
  - Hard copies
  - Microfilms
  - Scanned images of microfilms – black and white!
  - Have been imported into document system.

*Information  
where the bloody hell  
is it?*

## *2. Survey and Engineering Plans*

In addition, careful



located many 100s of plans at various offices  
across GMW

*Information  
where the bloody hell  
is it?*

## *2. Survey and Engineering Plans*

### Scanning Microfilms



Not best option



Should have scanned  
originals





*Information  
where the bloody hell  
is it?*

## *2. Survey and Engineering Plans*

To search for plans you need:

- Plan No. – if you could be so lucky!
- Name of plan and type, e.g. Contour, drainage
- Parish
- Crown details
- Looking for a water storage?
  - Name of storage
  - type

*Information  
where the bloody hell  
is it?*

### *3. Survey Benchmark Information*

- Benchmark terminology
  - SR/56/Y34
  - RWC/90/Z16
  - GMW/2012/D16
- All benchmark cards are scanned
- Copies of all benchmark cards available at time of transfer from Rural Water Corporation.
- Locality plans available
- Available in SMES, but should check with GMW for latest elevation



*Information  
where the bloody hell  
is it?*

# 3. Survey Benchmark Information Examples

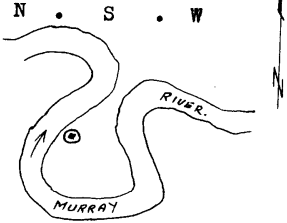
S.R. & W.S.C.		SURVEY DIVISION		BM RECORD	
NUMBER SR / 76 / A 127	DATUM AUSTRALIAN HEIGHT DATUM 72	ELEVATION 97.944	ZONE Northern		
Description Type 30cm Steel Spikes Plate attached to Red Gum Tree Marked by Alloy Number Plate		Position Millewa State Forest N . S . W  VICTORIA Grid Ref 239322 Parish COCOMAH PM No.			
Established in connection with Murray River Survey					
Date 7 - 10 - 76	Level Book 8049/ 42				
Plan SY 005	Field Book				

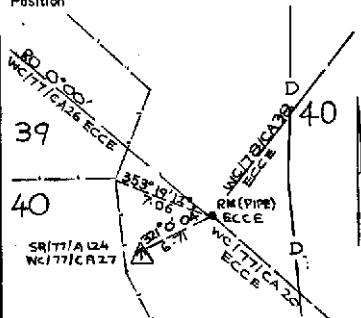
S.R. & W.S.C.		SURVEY DIVISION			COORDINATED MARK RECORD	
NUMBER WC / 77 / C A 27	AREA M.V.I.D.	B.M. NO SR/ 77 / A 124C	P.M. NO 151	OTHER REF.		
Coordinates (A.M.G. Zone 55 & A.H.D.)		Position				
E	364458.233	Stand. Dev'n				
N	6030952.666					
EL. 109.231 AUSTRALIAN HEIGHT DATUM 72						
Ref. Plan No						
Description Type S.P.M. Plate attached to Cono. Marker Post Marked by						
Date / Surveyor	DEC. 77 G.B.V.	SR77/A124 WC/77/C A 27				
Level Field Book	P 0506	Parish STRATHMERTON Ht./Scale Factor				
E.D.M. Instrument	A.G.A. 75					
Method of Co-ord Adjustment						
Comments SY 219						

*Information  
where the bloody hell  
is it?*

### *3. Survey Benchmark Information*

To search for a benchmark you need:

- Benchmark No. taken from marker post.
- Parish
- Crown details
- Road names and locality

***GMW will charge a fee for searching out  
information***

*Information  
where the bloody hell  
is it?*

## *4. Order in Council plans*

- Legal plans showing wide range of lands affected by water works, drainage works, sewerage works, irrigation districts and extensions and deletions.
- All have been scanned and imported into GMW document system as black and white.



- Rescanned in colour to show various areas and meanings. Not yet imported.

*Information  
where the bloody hell  
is it?*

## 4. Order in Council plans

- Approximately 7000 contained in secondary storage at GMW.

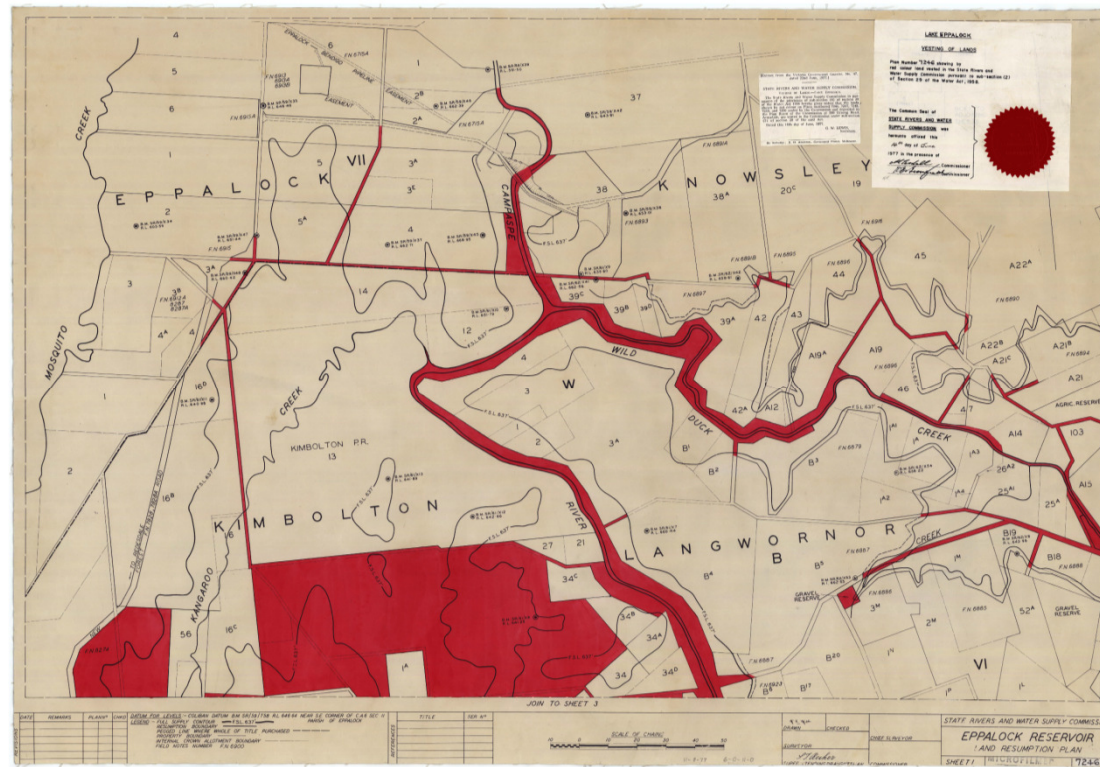

*Information  
where the bloody hell  
is it?*

## *5. Microfilms – Fieldnotes and Plans*

- Stored at GMW in a fire proof safe in the secondary storage area.
- Microfilm is recommended for longevity of information
- No working microfilm reader



*Information  
where the bloody hell  
is it?*

## *6. Corporate Files*

- Approximately 60,000 transferred to GMW. Remainder transferred to various water authorities.
- Metadata imported into GMW document system.
- Many 1000s of files relocated to Public Records Office in Melbourne
- Water storage files have to remain with relevant water authority.



*Information  
where the bloody hell  
is it?*

## *7. Level and Survey Fieldbooks*

- GMW holds 100s of level and survey fieldbooks of original surveys.
- Held in secondary storage at Tatura.
- Cannot be destroyed under Public Records legislation
- Other water authorities – unknown

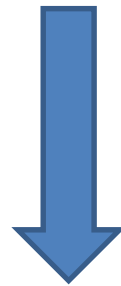

Destroyed?

*Information  
where the bloody hell  
is it?*

*Finally*

Where does this information belong?



GMW or Surveyor General



Surveyor General – safer bet!



*Information  
where the bloody hell  
is it?*

*Finally*

What information needs to be transferred?



- Fieldnotes – Hard copy and scans
- Benchmarks and locality plans
- Order in Council plans and scans
  - Microfilms for safer storage

*Information  
where the bloody hell  
is it?*

*Finally*

What needs to take place?



- Acceptance in principle by Surveyor General
  - Develop business case for transfer
  - Approve business case by all parties
    - Initiate transfer

*Information  
where the bloody hell  
is it?*

*Finally*

*Who the bloody hell is  
going to fund it?*

*Information  
where the bloody hell  
is it?*

## *Acknowledgements*

*Glenn Collins – Survey Manager*

*[glennc@g-mwater.com.au](mailto:glennc@g-mwater.com.au)*

*Avni Bekirofski – Senior Draughting Officer*

*[avnib@g-mwater.com.au](mailto:avnib@g-mwater.com.au)*



BACKSIGHT and FORESIGHT

**26th**  
**ISV Regional Conference**

**22-24 March 2013**

*Information  
where the bloody hell  
is it?*

# *Questions*